

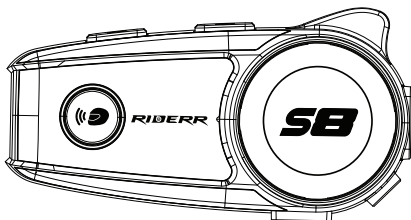

SCS S-8

Helmet Bluetooth Intercom



Operation Manual

(Attention)

Thank you for purchasing S-8 helmet Bluetooth intercom .
For best use experiences , please read manual before use .

Installation



Dock Station



Clip



3M double-sided tape
(As Adhesive for Helmet)



Silicone Pad
(For clip Installation)

3 Ways for Installation

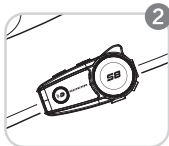

2. Installation with adhesive

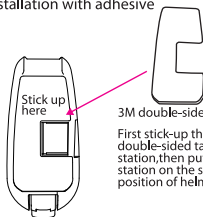

3M double-sided tape

First stick-up the 3M double-sided tape to the dock station, then put the dock station on the suitable position of helmet.

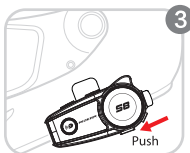

Fixed the S8 to the dock station, installation completed.

1. Clip



Silicone Pad



Clip

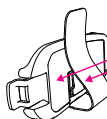

After installation, we can see clip here.

First stick up the silicone pad to dock station, then put the clip into dock station, now we can put the dock station on the suitable position of helmet.

3. Installation with 3M double-sided tape+Clip

If two ways above still not stable, we can try use these two ways for installation at the same time.

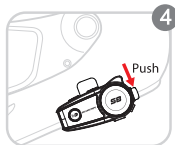

Take off the S8: Push the dock station from the right as picture shows, slide-up the 3M.

Remark: Mic should be close to the mouth, and speaker close to ear. If the installation of speakers are too deep from the ear, we can use the foam pad to make it closer.

Operation

1.Outlook / Function

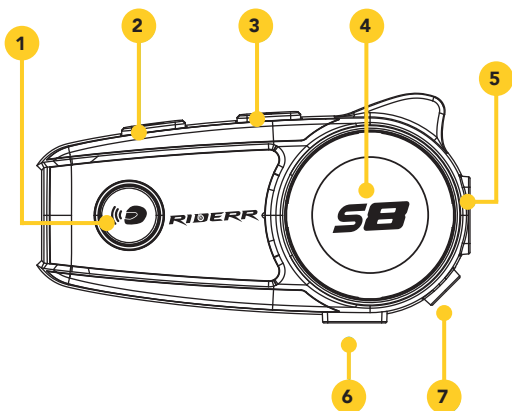

- 1** Intercom
- 2** Volume - / Previous
- 3** Volume + / Next
- 4** Function
- 5** Charge / Data
- 6** Headphone & Mic Kits
- 7** Aux In

2. Charge

2.1 How to Charge

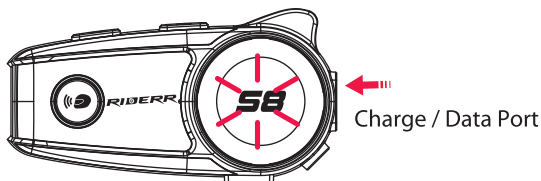

For first time use , please recharge the device until the red light is off .

1. Connect the cable with device and PC USB port ;
2. After cable connected , the red light on and start to charge , when battery is full , the red light will be off automatically . (Need 2 hours to fulfill the battery) .

** Do not use power from car or motorcycle directly , unstable power may damage the device .*

2.2 Power Detect & Notification Function

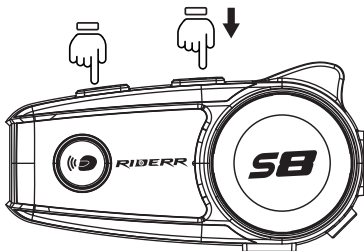

Low Power Notification: When power lower than 10% , red light flash in the function button and voice message will remind power lower than 10% , please recharge immediately .

Power Detect Function: S8 has power detect function , when device is on , short press volume - and volume + button at the same time , recorded voice message will tell you :

Power over 90%
Power over 50%
Power lower 50%
Power lower 10% please recharge immediately

3. Switch On / OFF

3.1 Switch On

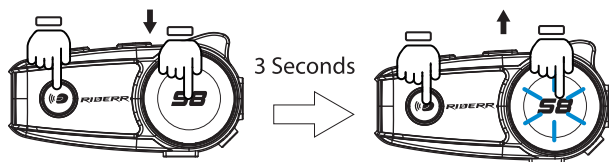

Press Intercom + Function button for 3 seconds until the LED indicator flash blue light , a voice prompt "Welcome to Bluetooth communication system" will be heard .

3.2 Switch Off

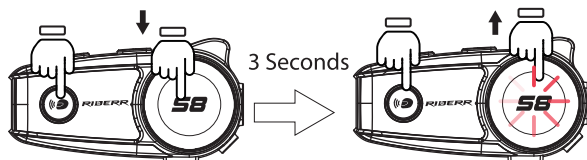

When device is on , press Press Intercom + Function button for 3 seconds until the LED indicator flash red light , a voice prompt "Power Off" will be heard .

4. Cellphone Function

4.1 Pair with Cellphone

STEP 1.

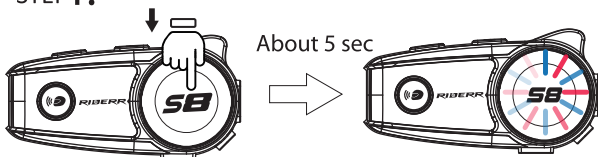

When device is on , long press function button, red and blue light flash in the function button , entering pairing mode .

STEP 2.

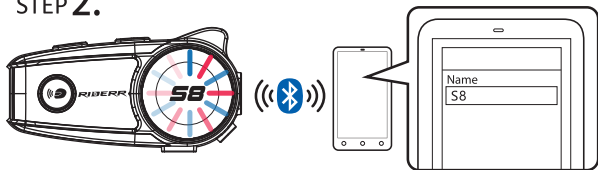

Switch cellphone Bluetooth , choose S8 , the pairing is complete .
Voice message will also say pairing complete .

Remark: when pairing complete , please check both cellphone audio and media audio are all chosen , otherwise call or music can not be processed .

4.2 Cellphone Function

Answering Call: Short press function once .

Hangup Call: After call , short press function once .

Refuse Call: Long press function button for 2 seconds .

Redial: Short press function button twice .

Volume Up: Press Volume + while talking .

Volume Down: Press Volume - while talking .

5. Voice Command



When your S8 is paired up with cellphone, Short press Volume + button twice, will automatically switch on the voice command function.

**Cellphone must equipped with this function .*

6. Music Play

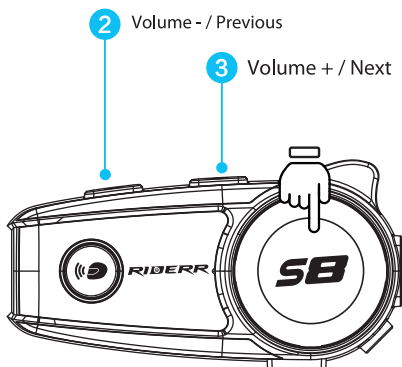

Play: When device is on , short press Function button.

Pause: When music is playing , short press Function button.

Volume Up : When music playing ,short press volume + once .

Volume Down : When music playing ,short press volume - once .

Play Previous:

When music playing ,long press volume - for 2 seconds .

Play Next: When music playing ,long press volume + for 2 seconds

7. Wire Connection

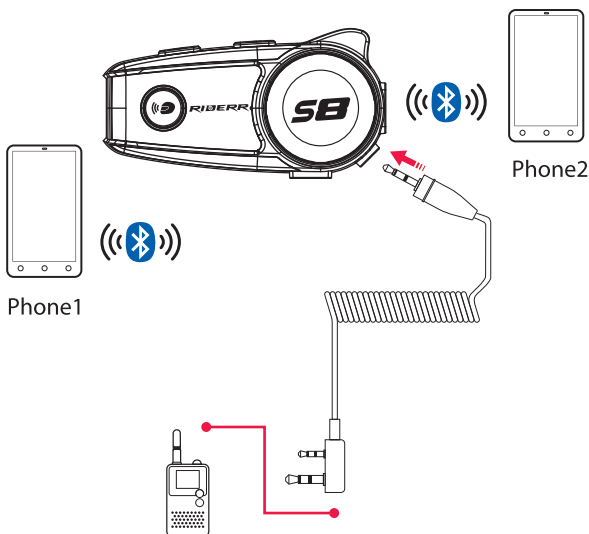

Two-Way Radio
(Needs professional radio connect cable)

Any device with 3.5mm connector can transmit voice signal to S8 .
through the transfer line.

8. Intercom Function (Rider to Rider)

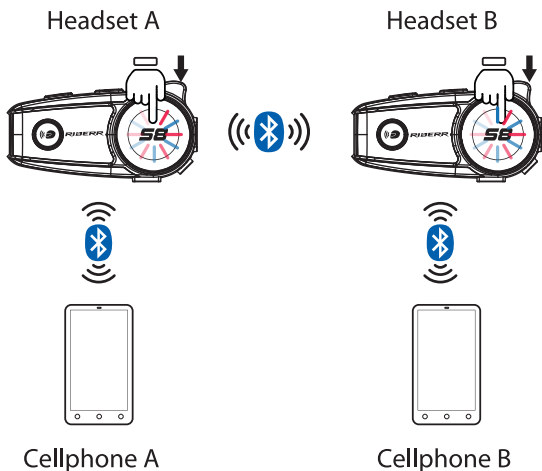

1. When device on , press both Headset A and B's function button until red and blue light to enter pairing mode .
2. Short press Headset A or B's intercom button , the red and blue light will be flashed slowly . once LED indicator turns into blue , the device connection completed .
3. After connection completed , you can switch on the intercom function by press any of the headset's intercom button .

9 . Memory Clean

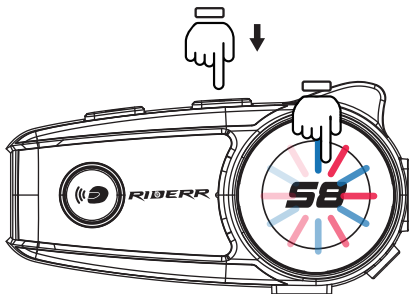

Memory Clear: When device is on , press Volume +, Volume - and function button at the same time for 3 seconds . Then S8 will clear the pairing memory with other devices .

10. Q&A

10.1 Q&A

Q1: No sounds from one or two side speaker

A1: Check device plug , needs to firmly connected

Q2: Can it be recharged from bike USB charger while riding ?

A2.1: Not recommended , unstable power source will cause damage on internal circuit , may cause unable to recharge/can't fully charged/can't switch on.

A2.2: Power bank will be good .

Q3: When using radio , not transmission or continuous transmission

A3: Check 2.5mm pin , has to insert firmly . The pin equipped with waterproof aprons , user might think its already plugged .

Q4: New device can't switch on

A4: Recharged at least 30 minutes before switch use .

10.2 Warning

10.21 Sound Volume Warning

Long period or too loud may hurt hearing ability .

10.22 Disassemble or Modification

The M6 is precisely made in factory . Any disassemble or modification may damage the device , please do not tear any of the safety regulation and serial sticker from the device , that will void the warranty . Please contact us directly if needed .

11.Statement

Herby,SUCCESS ETC TECHNOLOGY CO.,LTD declares that this Bluetooth intercom SCS S-8 is in compliance with the essential requirements and other relevant provisions of Directive 2014/53/EU. In accordance with Article 10(2) and Article 10(10), this product allowed to be used in all EU member states.

Use the Bluetooth intercom in the environment with the temperature between -10°C and 40°C

Use careful with the earphone maybe possible excessive sound pressure from earphones and headphones can cause hearing loss. Risk of explosion if battery is replaced by an incorrect type. Dispose of used batteries according to the instructions.

The product shall only be connected to a USB interface of version USB2.0

SAR: The device complies with RF specifications when the device used at 5mm from your body.

